



Just steps from Wall Street and offering the perfect customizable venue for your next large event. Equipped with a technology-friendly, stadium-style amphitheater, eight flexible breakout spaces, and reception space. With views of the East River and Brooklyn Bridge, this location is the best place to host your next training, seminar, or product launch in downtown New York City.

CONTACT FOR MORE INFORMATION:

DEB GALPER | AREA SALES MANAGER

dgalper@archamenity.com

914.523.9836

www.archamenityevents.com



BEST-IN-CLASS TECHNOLOGY



FLEXIBLE MEETING & EVENT SPACE



FIVE STAR HOSPITALITY SERVICE



DEDICATED EVENT PLANNING SERVICES



GOURMET CULINARY OFFERINGS

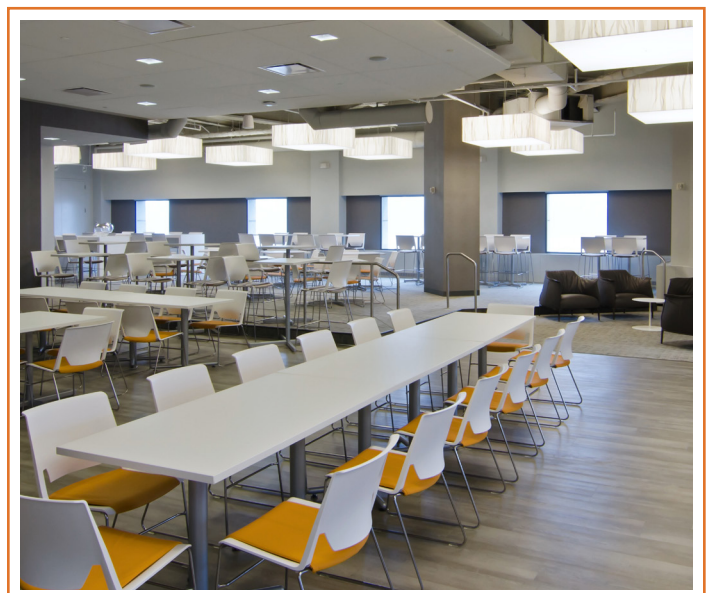

FLOORPLANS & CAPACITIES

32 OLD SLIP FLOORPLAN

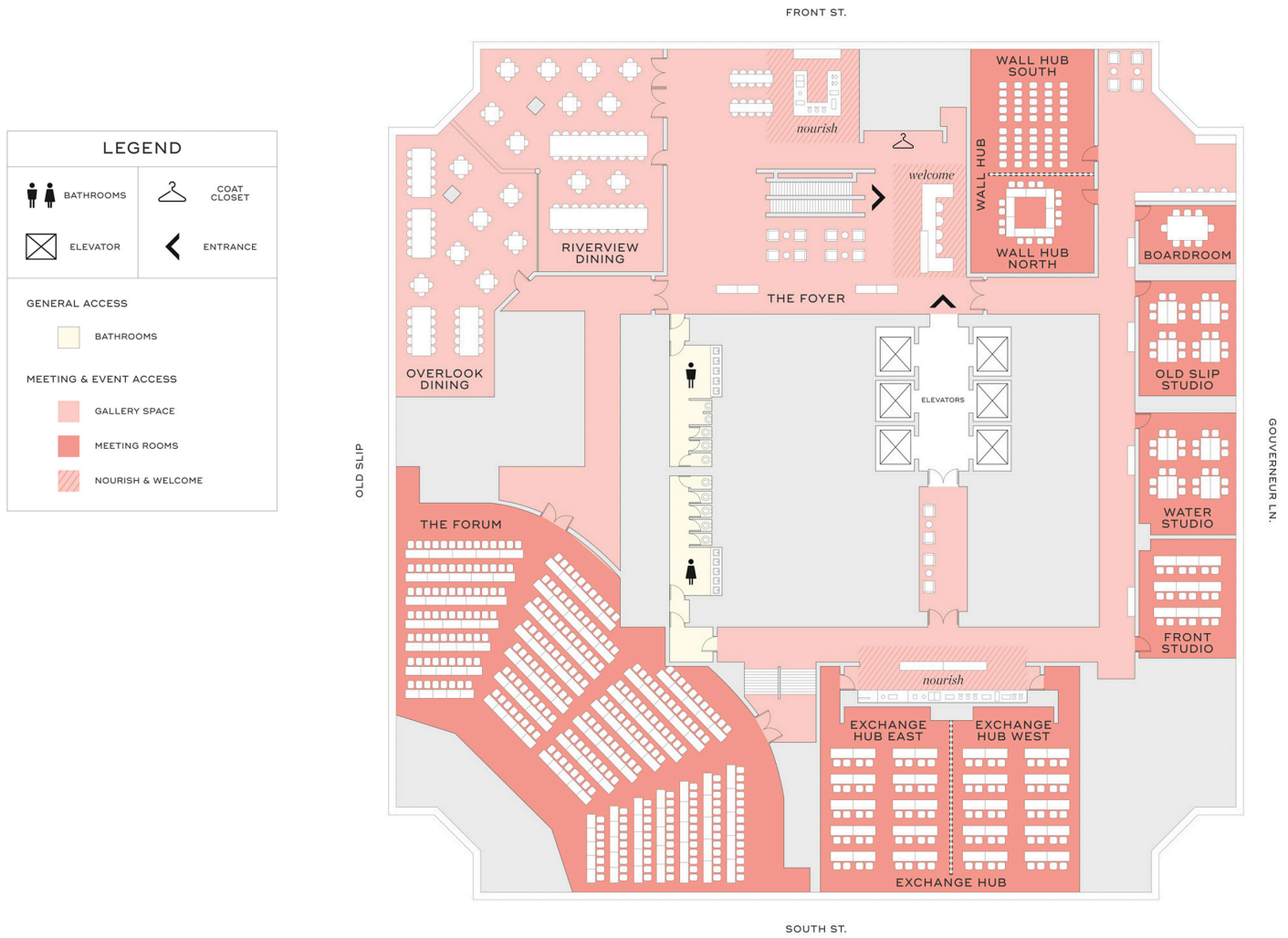

	DIMENSION	AREA	CEILING HEIGHT	RECEPTION	THEATER	CLASSROOM	CONFERENCE	U-SHAPE	HOLLOW SQUARE	PODS
THE FORUM	85' X 51'	4,335'	12'	N/A	N/A	212	N/A	N/A	N/A	N/A
EXCHANGE HUB EAST	40' X 28'	1,120'	9'	100	96	50	20	33	42	54
EXCHANGE HUB WEST	40' X 28'	1,120'	9'	100	96	50	20	33	42	54
EXCHANGE HUB	81' X 28'	2,274'	8'	200	192	100	48	45	48	96
FRONT STUDIO	24' X 21'	504'	9'	40	45	24	16	18	16	24
WATER STUDIO	24' X 21'	504'	9'	40	45	24	16	18	16	24
OLD SLIP STUDIO	24' X 21'	504'	9'	40	45	24	16	18	16	24
BOARDROOM	12' X 21'	252'	9'	N/A	N/A	N/A	8	N/A	N/A	N/A
WALL HUB SOUTH	24' X 26'	624'	9'	40	50	24	16	16	20	24
WALL HUB NORTH	24' X 20'	480'	9'	40	45	18	16	12	16	24
WALL HUB	24' X 46'	1,104'	9'	80	95	50	32	28	36	48
THE FOYER	N/A	2,250'	12'	100	N/A	N/A	N/A	N/A	N/A	N/A
OVERLOOK DINING	40' X 48'	1,920'	15'	150	N/A	N/A	N/A	N/A	N/A	N/A
RIVERVIEW DINING	56' X 30'	1,680'	16'	150	N/A	N/A	N/A	N/A	N/A	N/A